

FOR LEASE

URBAN
WORKS

TURN-KEY RETAIL SPACES

AVAILABLE | 1,037 - 1,438 SF



MASON
WILLIAMS

4140 & 4220 N WILLIAMS AVE

CHARLOTTE LARSON | 503.228.3080
WWW.URBANWORKSREALESTATE.COM



MASON
WILLIAMS



RETAIL 1 INTERIOR



About The Spaces

Delightful, turn-key retail spaces available on N Williams Ave. These spaces feature roll up doors, tall ceilings and beautiful natural wood trim throughout.

Retail 1

Space

4140 N Williams

1,438 SF

Timing

Available now!

Retail 2

Space

4220 N Williams

1,037

Timing

July 1, 2020



RETAIL 2 STOREFRONT

FLOOR PLAN

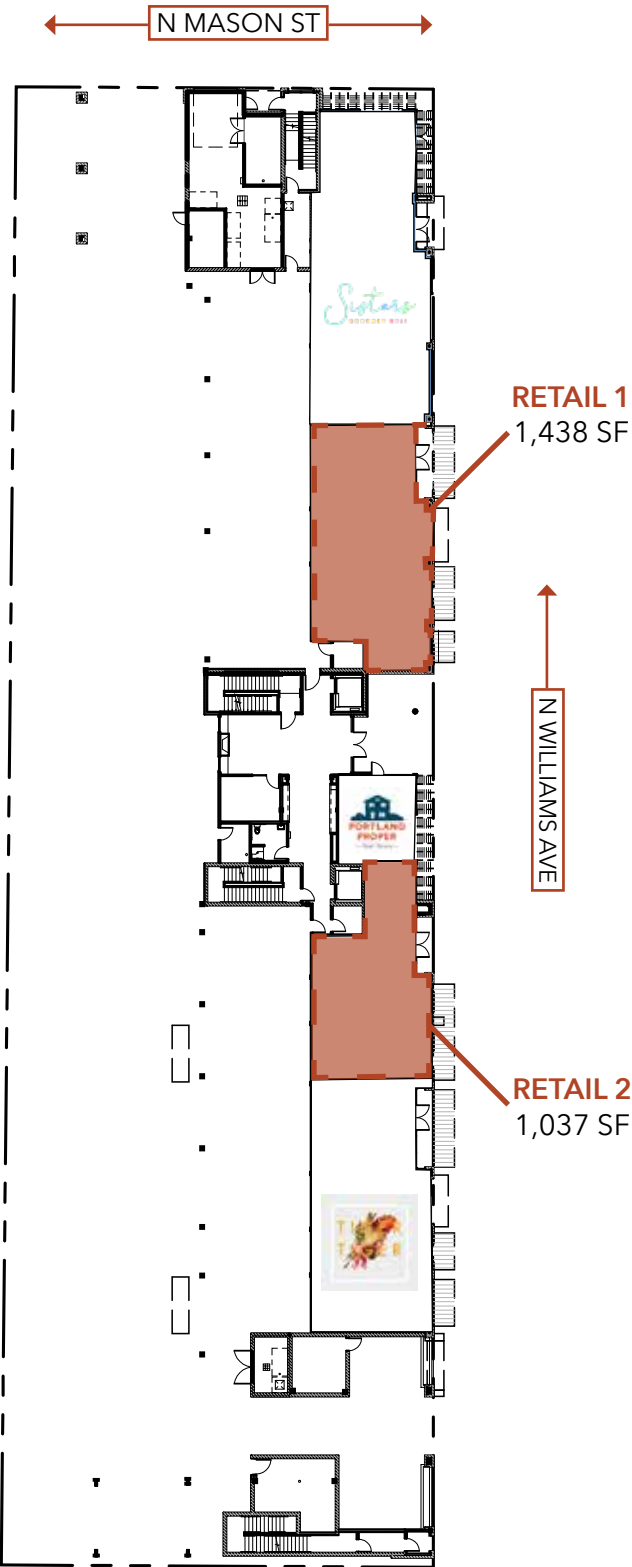

AREA RETAIL & DEMOS



	.25 MILES	.5 MILES	1 MILE
2019 POPULATION	2,866	10,201	30,238
TOTAL EMPLOYEES	557	3,370	19,132
TOTAL BUSINESSES	107	565	2,059
MEDIAN HH INCOME	\$81,919	\$79,449	\$82,914
MEDIAN AGE	34.8	34.2	34.8
SOME COLLEGE	81.62%	82.91%	83.63%



XLB



EEM



POA CAFE



BOX SOCIAL



EAT: AN OYSTER BAR



COCO DONUTS



VENDETTA

RETAIL MAP

