

FOR LEASE

URBAN
WORKS

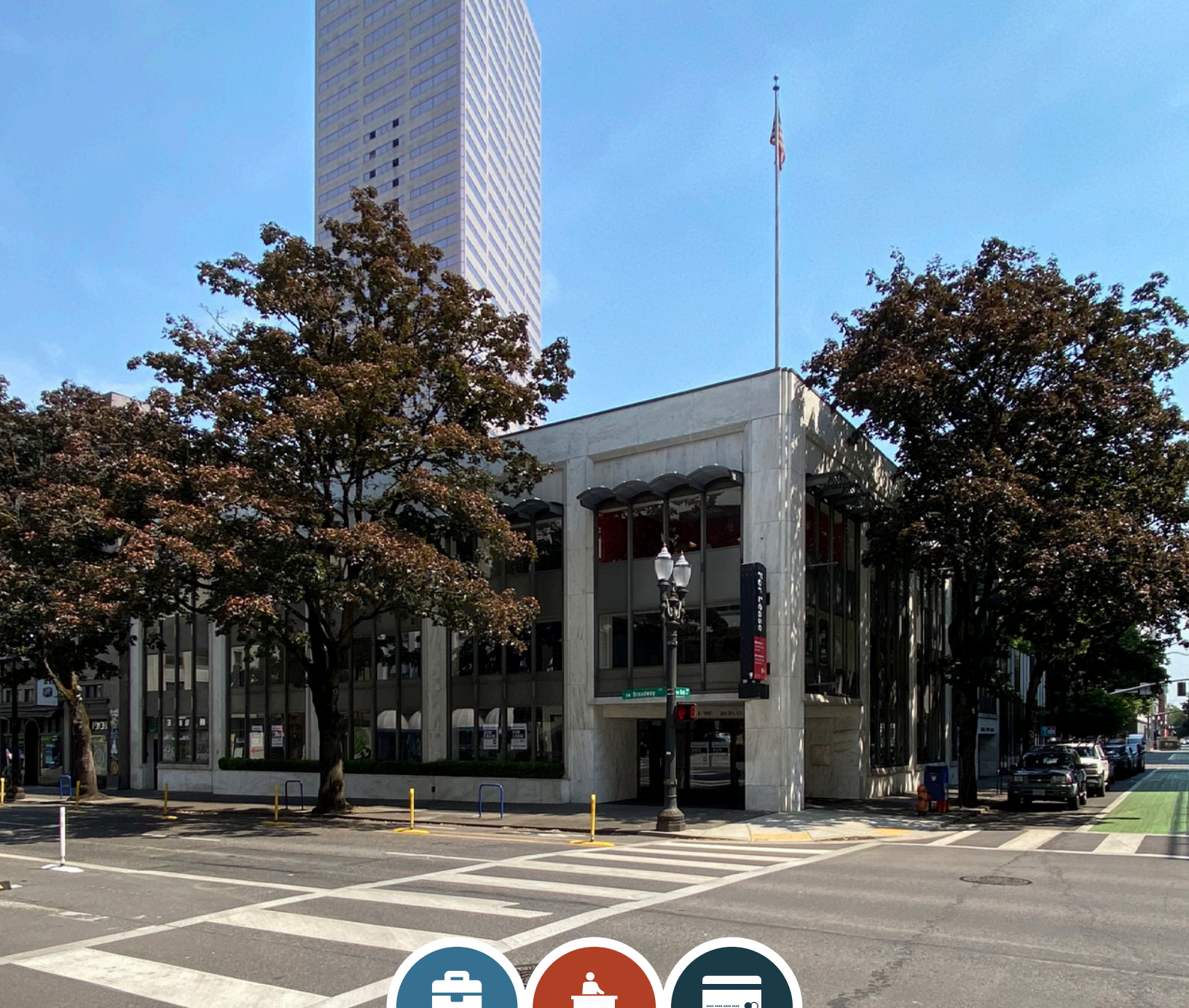

OFFICE



SERVICE



RETAIL

234 SW BROADWAY

17,302 SF TWO STORY OPPORTUNITY

DAN BOZICH | 503.228.3135
dbozich@urbanworksrealestate.com

BRIAN GREELEY | 503.228.3147
bgreeley@urbanworksrealestate.com

urbanworksrealestate.com

234 SW BROADWAY



About the Space

This building is centrally located between Portland's West End and Central Business District neighborhoods. With high ceilings and oversized windows, the space is perfect for Creative Office or Large Retail users. The space features a beautiful spiral staircase which connects the first and second levels. Secured parking available for tenants, located in an adjacent property.

Address

234 SW Broadway

Total Available Space - 17,302 SF

First Floor | 9,782 SF

Second Floor | 7,520 SF

Uses

Office / Retail / Service



FLOOR PLANS

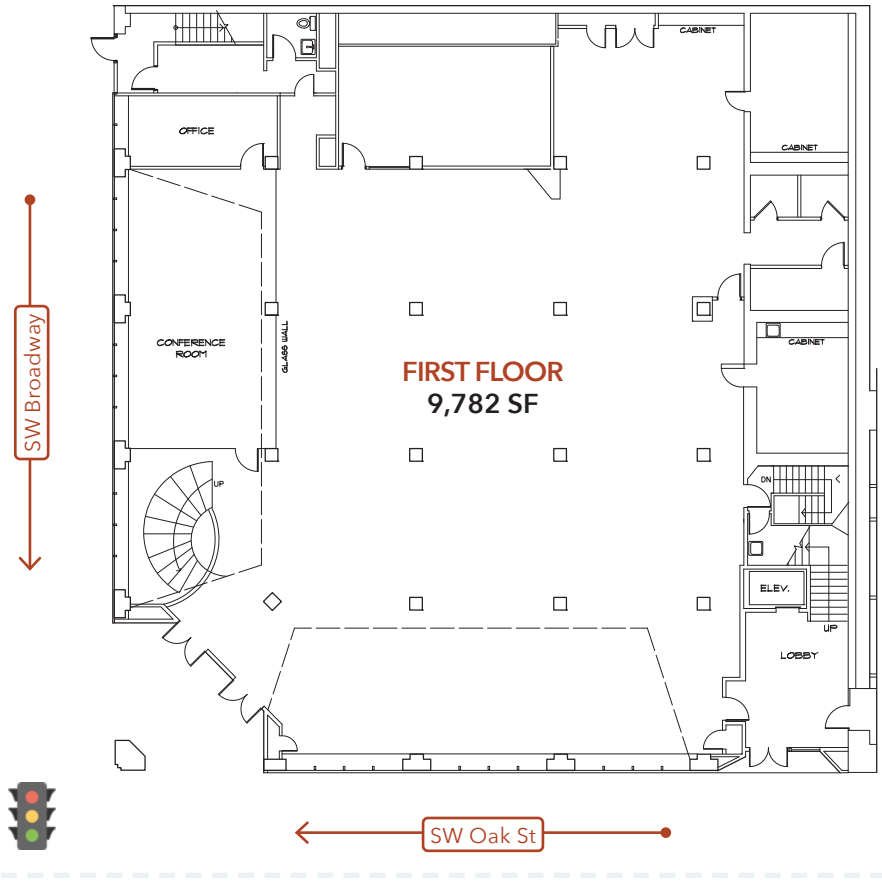

ADJACENT TO
SECURED PARKING
STRUCTURE AVAILABLE
FOR TENANTS

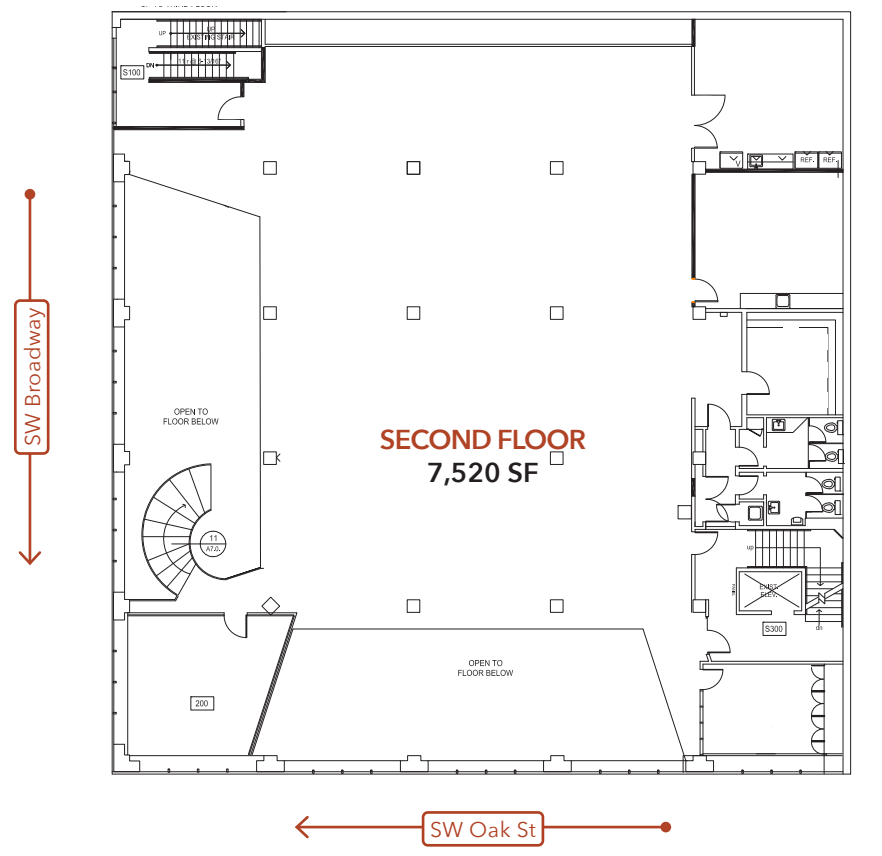

NEIGHBORHOOD



Demographics	¼ Mile	½ Mile	1 Mile
2023 Population	2,135	9,648	41,897
Total Employees	16,532	60,825	105,001
Total Businesses	1,400	4,965	9,003
Median Household Income	\$42,714	\$66,011	\$74,424
Median Age	45.8	43.3	38.2
Any College	63.8%	72.3%	83%



Kell's



Sizzle Pie



Bamboo Sushi



Shake Shack



Powell's Books



Grits N' Gravy



El Gaucho

RETAIL MAP



Midtown Beer Garden | Portland's oldest food cart pod is located one block from the space and recently reopened after undergoing an extensive remodel. The pod features more than 20 carts, 300 seats, live music and events within a two minute walk of this available space.

