

# FOR LEASE

URBAN  
WORKS

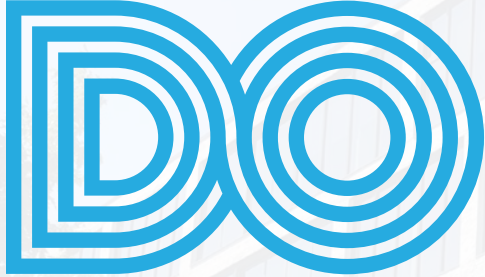

RETAIL | 1,713 RSF - 4,693 RSF



## DISTRICT OFFICE

### CENTRAL EASTSIDE GROUND FLOOR RETAIL

BRIAN GREELEY | 503.228.3147  
bgreeley@urbanworksrealestate.com

TYLER BRUSS | 503.228.3274  
tbruss@urbanworksrealestate.com

urbanworksrealestate.com



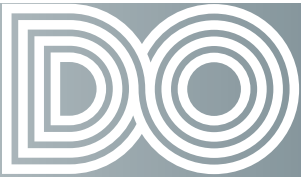

## About the Space

- New, ground-up, 6-story mass timber building (cross-laminated)
- Surrounded by trendsetting eateries, micro-distilleries, breweries, coffee roasters, studios and gallery space
- Easy access to Portland Streetcar and Bus Lines
- Off-street loading
- Located across the street from a 57 room boutique hotel restoration project by Beam Development & UD+P
- In the Central Eastside there are approximately 3,250 new residential units delivered in the last 3 years
- Chase ready to receive Type 1 Hood

## Address

525 SE MLK Jr Blvd

## Area

Central Eastside

## Ground Floor Retail

1,713 RSF - 4,693 RSF

## Timing

Available Now

## Uses

Retail / Restaurant / Taproom

## Traffic Count - SE MLK Jr Blvd & SE Stark St

19,066 Average Daily Traffic



# SITE PLAN



RETAIL 1 PATIO SPACE

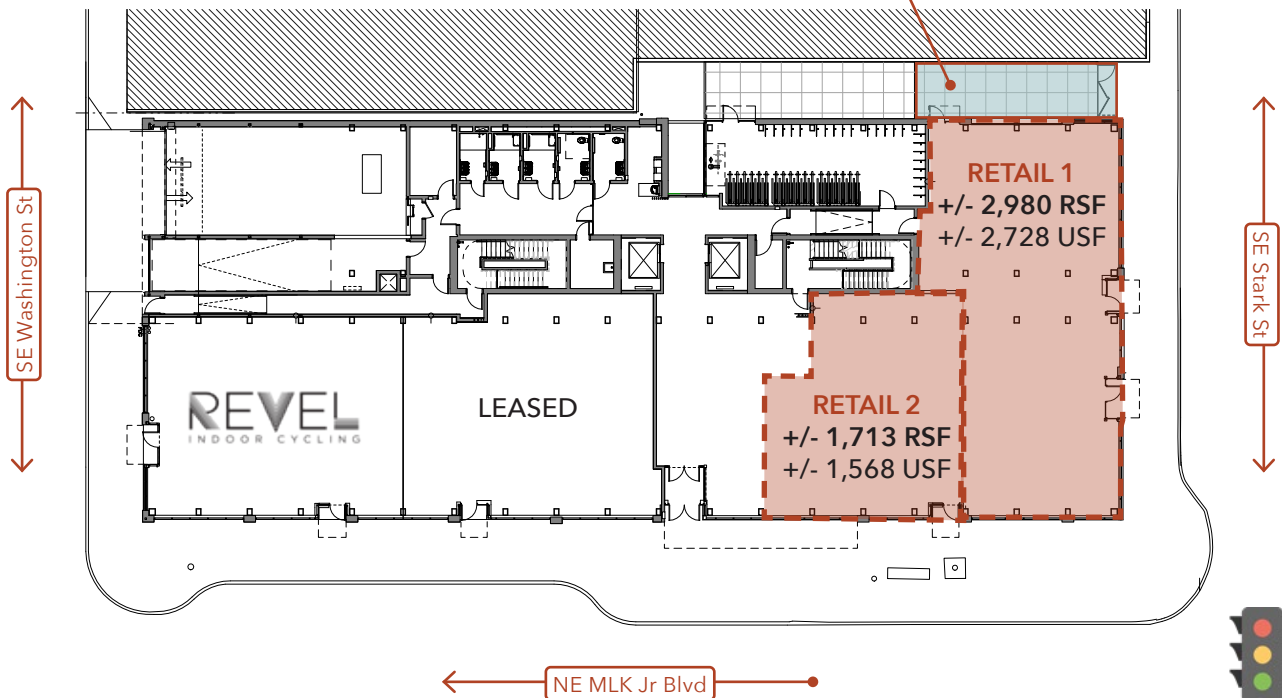

19,066 ADT  
THRU INTERSECTION



# NEIGHBORHOOD



Demographics	¼ Mile	½ Mile	1 Mile
2022 Population	782	3,851	24,969
Total Employees	4,428	13,477	101,307
Total Businesses	497	1,470	7,989
Median Household Income	\$62,337	\$61,427	\$57,633
Median Age	36	34.6	36.6
Any College	78.3%	82%	81.3%



Next Adventure



Ranger



Danwei Canting



Produce Row



Shalom Y'all



Wayfinder



Pacific Standard



# RETAIL MAP

URBAN  
WORKS

