

FOR LEASE

URBAN
WORKS



GALLERIA



CAFE



RETAIL



SERVICE

HIGH TRAFFIC RETAIL OPPORTUNITY

600 SW 10TH AVE, SUITE 106 | 1,098 SF

DAN BOZICH | 503.228.3135
dbozich@urbanworksrealestate.com

KIA HARTLEY | 503.228.3209
khartley@urbanworksrealestate.com

urbanworksrealestate.com



Address

600 SW 10th Ave

Area

Downtown PDX

Space

1,098 SF

Uses

Cafe / Retail / Service

About the Building

Prime retail space with highly visible glass line located adjacent to Target and below Class A office space. The available storefront is across from the highly anticipated Ritz Carlton and perfectly situated in Portland's shopping district. The space's beautiful storefront windows provide incredible exposure to the strong traffic counts at the intersection of SW 10th Ave and SW Alder St.



SITE PLAN

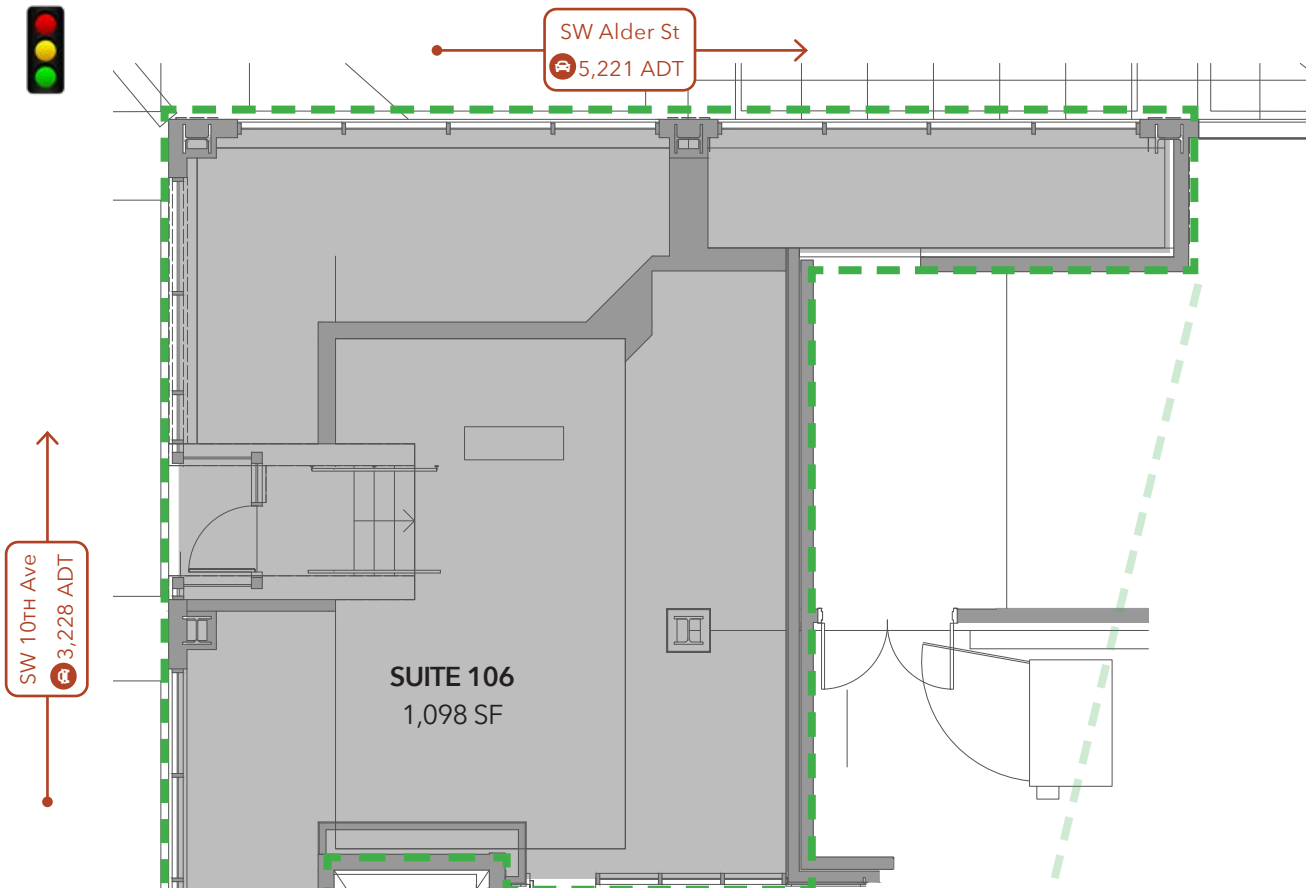

The Ritz Carlton -

The Galleria is steps away from the highly anticipated Ritz Carlton Residences. The Ritz features 132 luxury residences; 250 five-star hotel rooms; Bellpine, a Michelin Star chef's signature restaurant; Flock, a ground breaking food hall concept; Packouz Jewelers, Portland's official Rolex jeweler - all combined in this 35 story LEED Gold building.

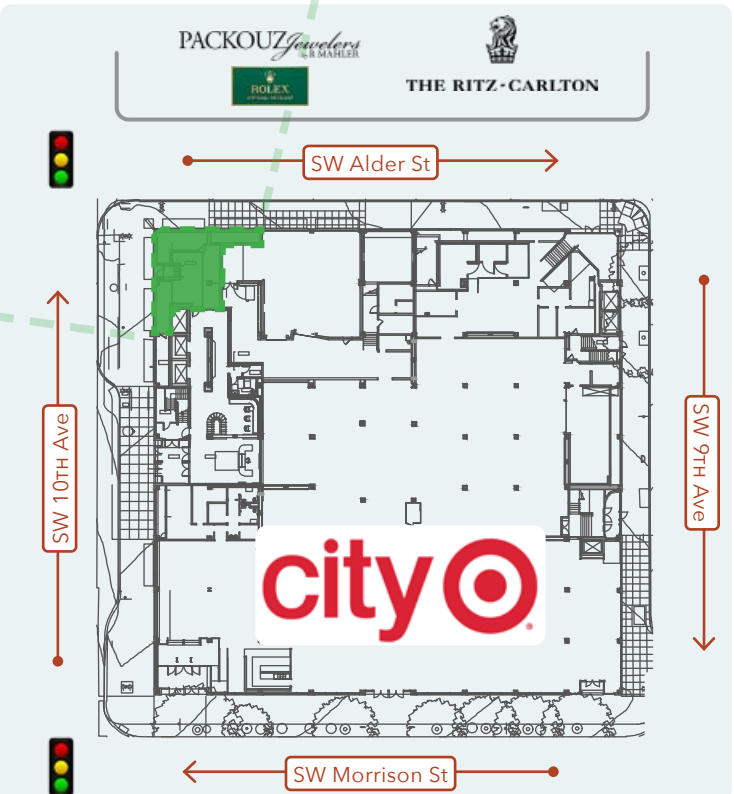

NEIGHBORHOOD



| Demographics | ¼ Mile | ½ Mile | 1 Mile |
|-------------------------|----------|----------|-----------|
| 2023 Population | 1,772 | 14,055 | 44,270 |
| Total Employees | 21,455 | 63,711 | 102,223 |
| Total Businesses | 1,893 | 5,214 | 8,978 |
| Median Household Income | \$55,707 | \$62,352 | \$102,223 |
| Median Age | 44.2 | 42.5 | 38.5 |
| Any College | 69.5% | 78.4% | 83.8% |



INFORMATION CONTAINED HEREIN IS FROM SOURCES DEEMED RELIABLE, BUT NOT GUARANTEED.