

FOR LEASE

URBAN
WORKS

BLOCK 90

AVAILABLE | 3,702 RSF

COVERED OFF-STREET
LOADING/DELIVERY AREA

80' of Frontage Along NW Flanders St

YOUR SIGN



RETAIL



SERVICE

PEARL DISTRICT RETAIL SPACE

1332 NW FLANDERS ST

DAN BOZICH | 503.228.3135
dbozich@urbanworksrealestate.com

KIA HARTLEY | 503.228.3209
khartley@urbanworksrealestate.com

urbanworksrealestate.com

BLOCK90



About the Building

This historic warehouse building was constructed in 1938 and fully redeveloped in 2008 with three levels of commercial space and fourth floor luxury townhomes. This mid-block retail space is surrounded by premier restaurants, breweries, retail and offices including the Aveda Institute and CENTRL Office.

Floor Plan

Address

1332 NW Flanders St

Area

Pearl District

Space

3,507 USF / 3,702 RSF

Timing

Available Now

Uses

Retail / Service

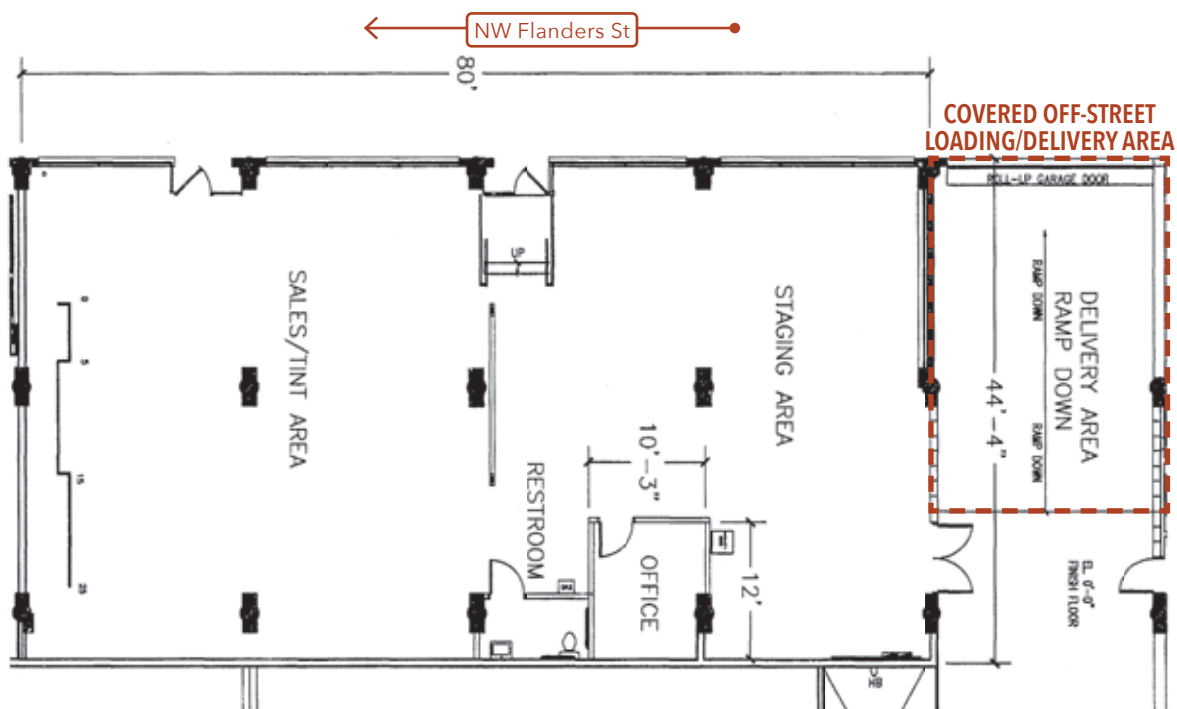

NEIGHBORHOOD



Demographics	¼ Mile	½ Mile	1 Mile
2023 Population	4,243	17,515	44,428
Total Employees	11,860	36,174	99,579
Total Businesses	937	3,537	8,809
Median Household Income	\$110,160	\$80,130	\$79,195
Median Age	38.7	37.9	39
Any College	92.0%	84.5%	84.6%



24 Hour Fitness



10 Barrel



Blu Dot



Revolvr



Filson



Design Within Reach



Superdeluxe

RETAIL MAP

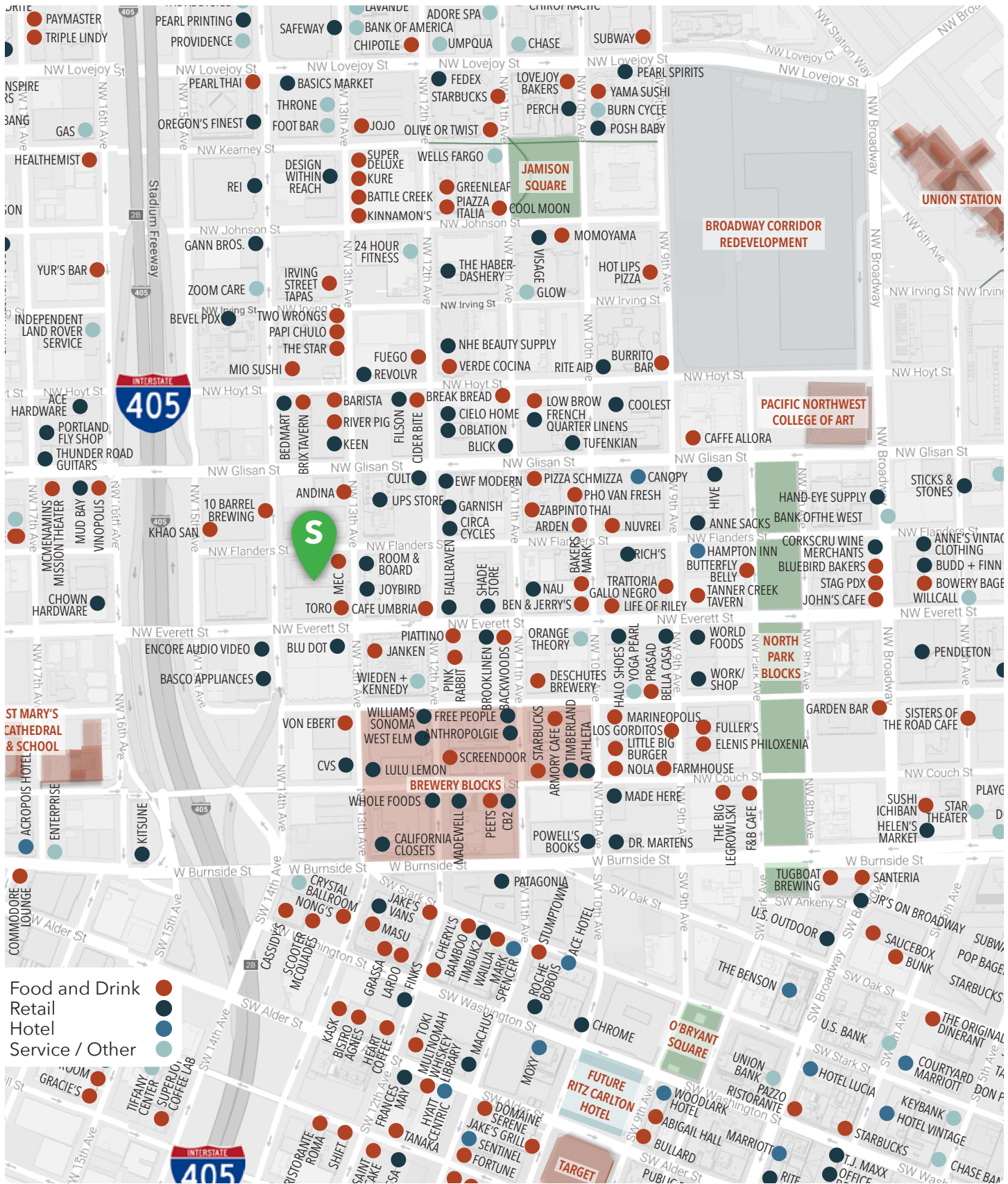

INFORMATION CONTAINED HEREIN IS FROM SOURCES DEEMED RELIABLE, BUT NOT GUARANTEED.