

FOR LEASE

URBAN
WORKS



TURN-KEY CAFE @ 3917 N MISSISSIPPI AVE

CHARLOTTE LARSON | 503.228.3165 | clarson@urbanworksrealestate.com
urbanworksrealestate.com

3917 N MISSISSIPPI

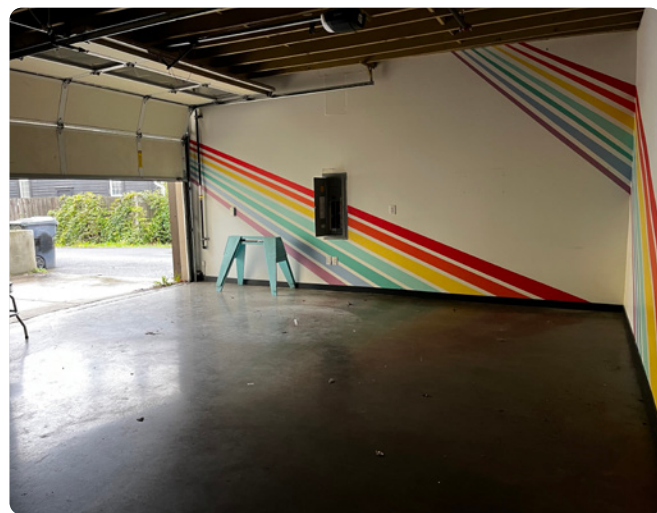

Address

3917 N Mississippi

Area

N Mississippi

Space

2,208 SF

Timing

Available Now

Uses

Cafe / Retail

Space Features

Turn-key cafe space in wonderful location on N Mississippi Ave. Recent improvements include: counter / seating areas, cafe plumbing, grease trap, two ADA bathrooms. The space includes a back room with roll-up door for deliveries.



FLOOR PLAN

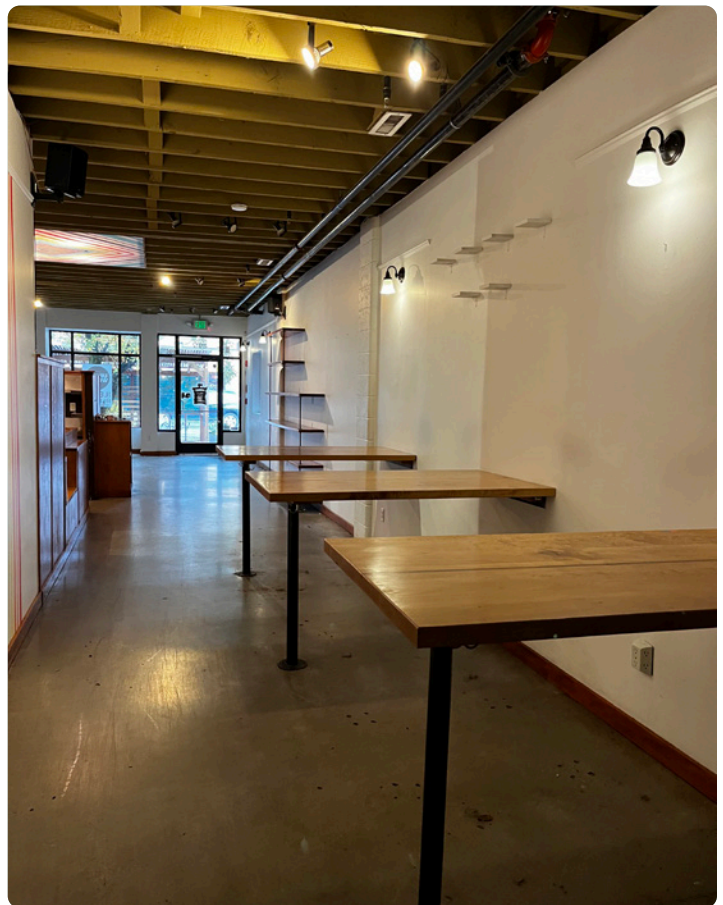
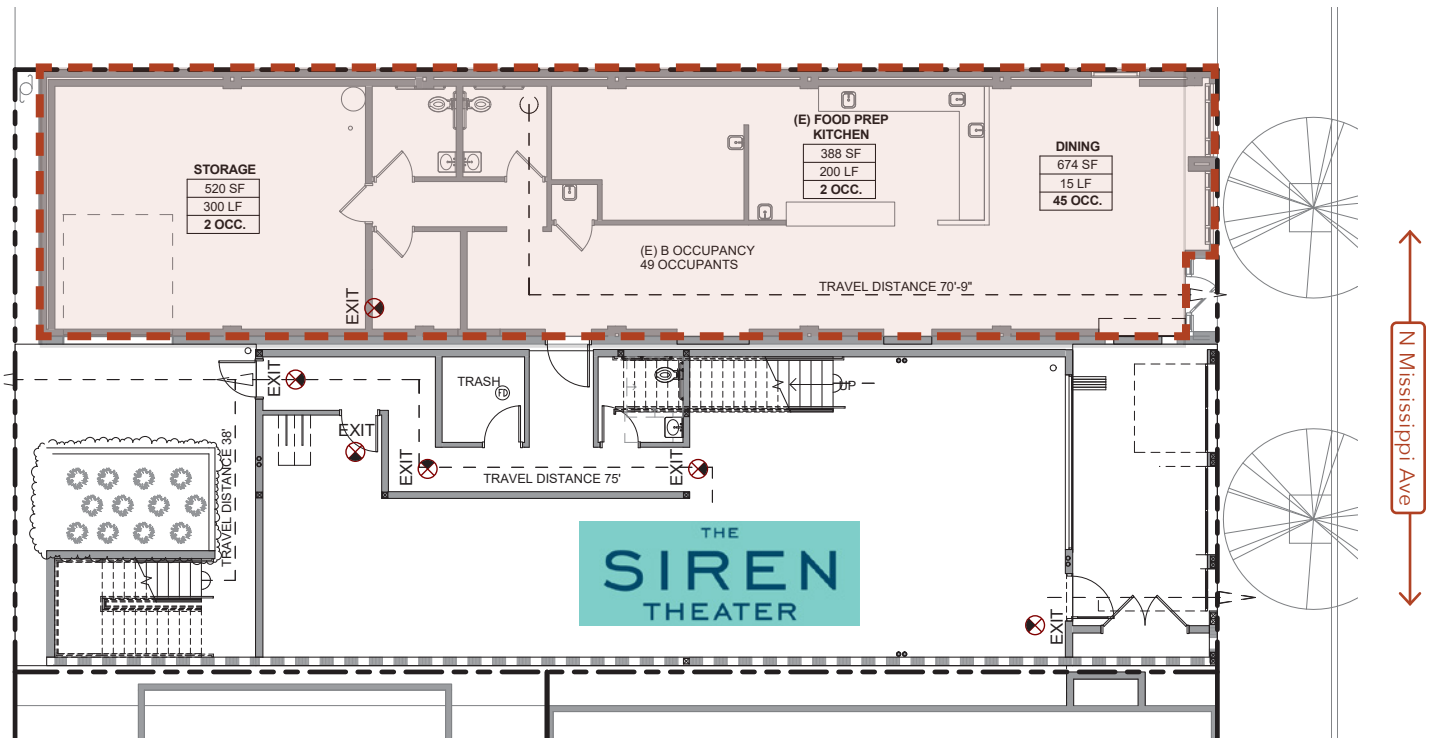

NEIGHBORHOOD

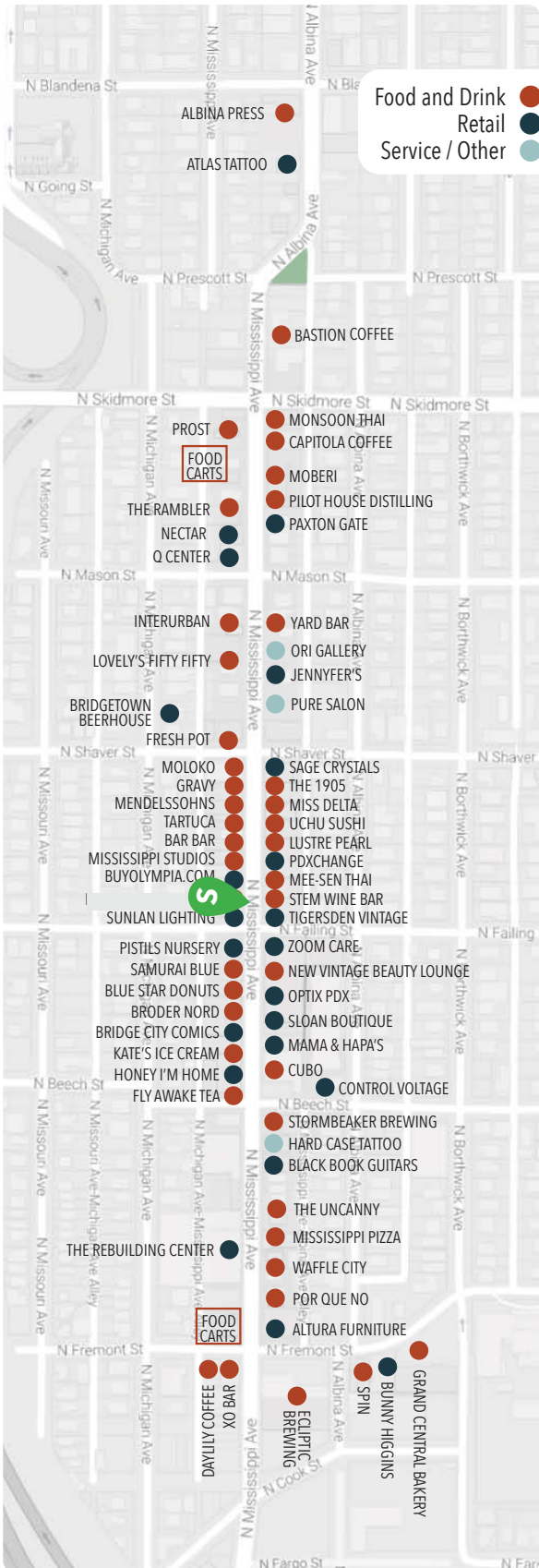

Demographics	¼ Mile	½ Mile	1 Mile
2023 Population	2,188	8,953	25,989
Total Employees	1,299	3,488	16,895
Total Businesses	195	545	1,917
Median Household Income	\$94,738	\$103,858	\$98,847
Median Age	33.6	35	35.4
Any College	88.4%	87.1%	85.7%

