



FOR LEASE

URBAN
WORKS

1829 NW 25TH AVE | PORTLAND, OR



**FREESTANDING BUILDING WITH PARKING
APPROXIMATELY 10,140 SF + 2,000 SF MEZZANINE**

DAN BOZICH | 503.228.3135
dbozich@urbanworksrealestate.com

KIA HARTLEY | 503.228.3080
khartley@urbanworksrealestate.com

urbanworksrealestate.com

1829 NW 25TH AVE

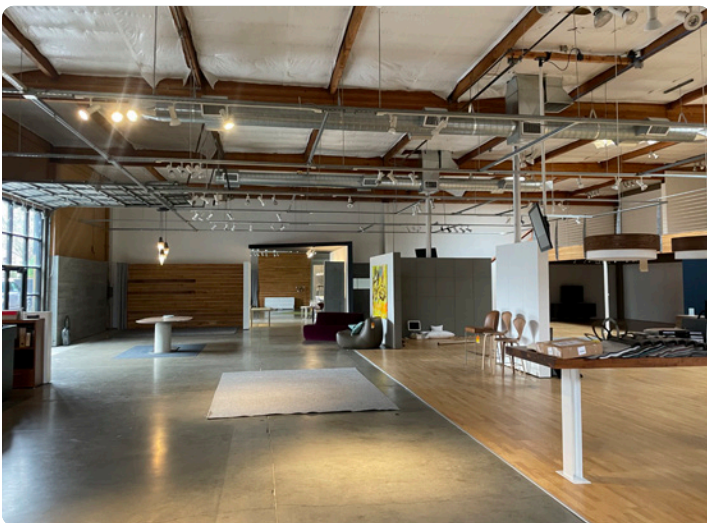

Address

1829 NW 25th Ave

Area

Slabtown

Space

Total: 10,140 SF + 2,000 SF Mezzanine Space
Divisible to 6,740 SF

Uses

Showroom / Retail

Features

This standalone building is perfectly situated near Slabtown on the corner of NW 25th Ave & NW Upshur Street. The building is conveniently located to provide easy access to freeways and Downtown Portland. The space features approximately 10,140 SF of retail or showroom space with 2,000 SF of mezzanine spaces accessed by staircases.

Additional amenities include:

- Grade level loading door (clear glass)
- Polished concrete floors & wood floors
- Built-out office space
- Five off-street parking stalls with potential for up to nine total spaces

SITE PLAN



Rear Mezzanine

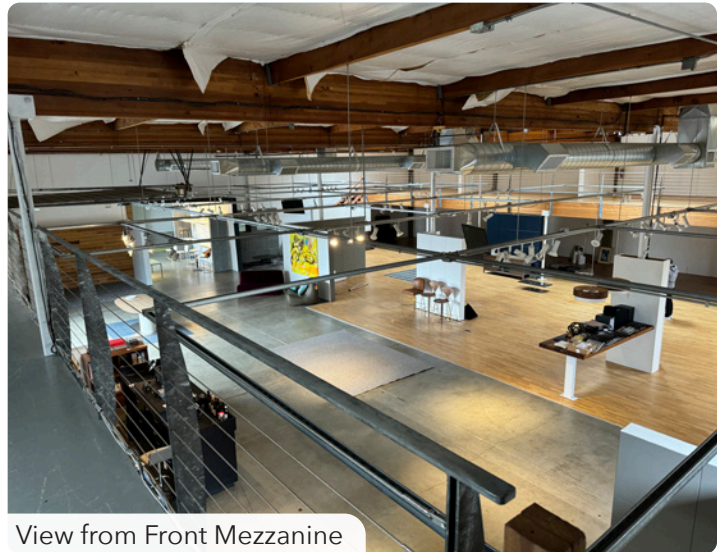

View from Front Mezzanine

TOTAL SPACE | 10,140 SF + 2,000 SF Mezzanine Spaces

DEMISING OPTION |

+/- 3,400 SF

+/- 6,740 SF

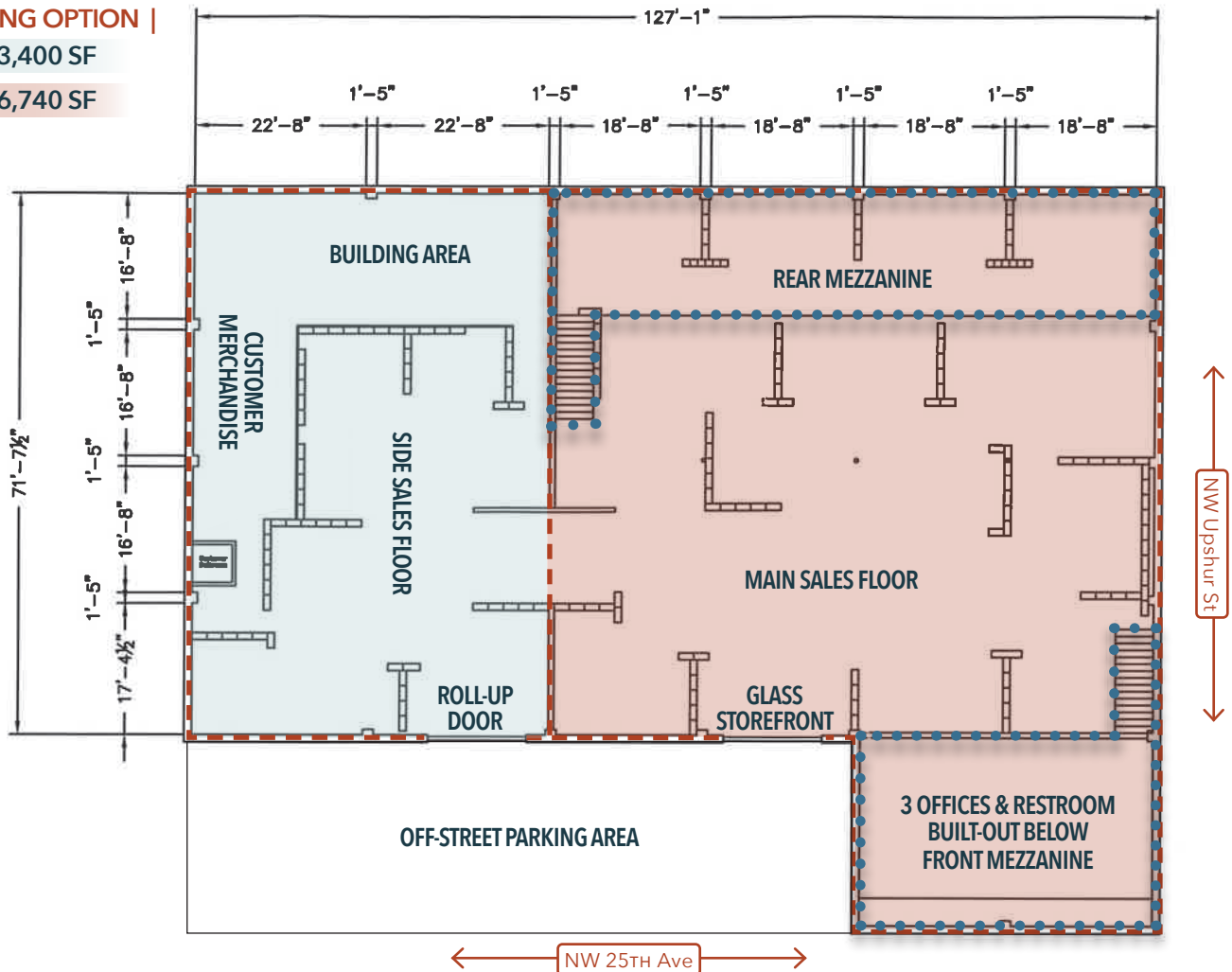

SLABTOWN AREA



New Seasons

Demographics	¼ Mile	½ Mile	1 Mile
2023 Population	1,902	6,996	23,228
Total Employees	1,171	10,003	27,881
Total Businesses	163	1,054	2,955
Median Household Income	\$122,973	\$115,283	\$102,903
Median Age	38.9	39.2	38.3
Any College	93.5%	93.9%	91.5%

