

FOR LEASE

URBAN
WORKS

THE UNION

1035 NE MLK JR BLVD



CAFE



RETAIL



CREATIVE



SERVICE

**HIGHLY VISIBLE RETAIL SPACES NEAR PORTLAND'S
CONVENTION CENTER | 1,390 SF - 1,850 SF**

TYLER BRUSS | 503.228.3274 | tbruss@urbanworksrealestate.com
urbanworksrealestate.com



Address | 1035 NE MLK Jr Blvd

Area | Lloyd District

Uses | Cafe / Creative / Retail / Service

Available | Space A | 1,520 SF
 Space B | 1,390 SF
 Space C * | 1,850 SF
 * Second Generation Cafe

The Union | Centrally located in Portland's Lloyd District, The Union provides exceptional accessibility to every quadrant of the urban core and features 185 market rate apartments with nearly 400 current residents. The available retail spaces offer expansive glass lines and high visibility from NE Multnomah Street. Ideally situated next to the new Hyatt Regency Convention Center Hotel, which offers 600 rooms attracting a large audience coming to Portland for business and travel, The Union is an excellent opportunity to provide services to a part of Portland that is expanding at a rapid rate!



INFORMATION CONTAINED HEREIN IS FROM SOURCES DEEMED RELIABLE, BUT NOT GUARANTEED.

SITE PLAN

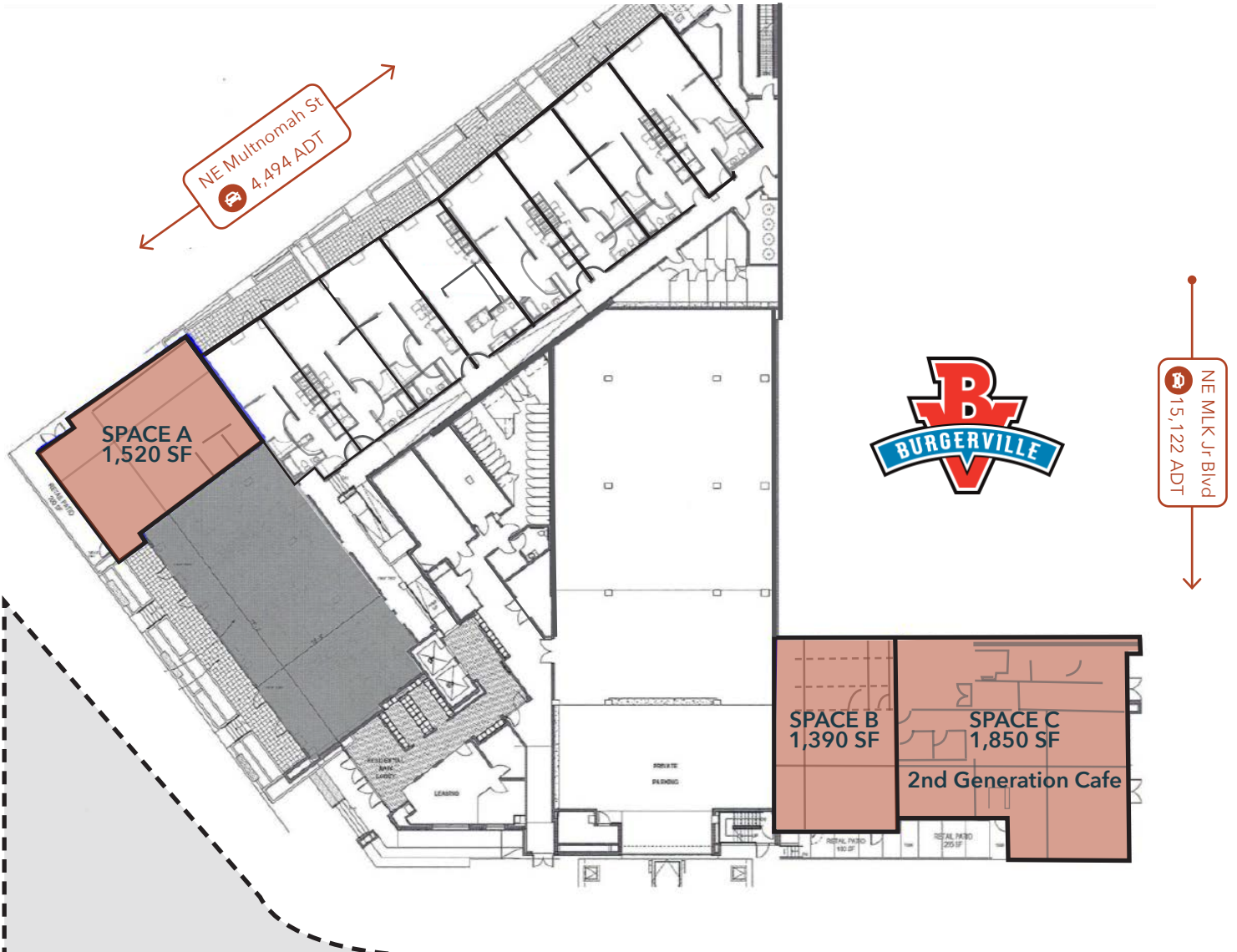

Space A

NEIGHBORHOOD



Demographics	¼ Mile	½ Mile	1 Mile
2023 Population	2,457	4,244	29,513
Total Employees	5,761	17,789	54,592
Total Businesses	197	937	4,768
Median HH Income	\$70,977	\$73,238	\$76,728
Median Age	36.4	36.2	38.5



Moda Center



Hyatt Convention Center Hotel



Oregon Convention Center



INFORMATION CONTAINED HEREIN IS FROM SOURCES DEEMED RELIABLE, BUT NOT GUARANTEED.