

FOR LEASE

URBAN
WORKS

SECOND GENERATION BAR / RETAIL

SIZE RANGE | 580 SF - 1,163 SF

AVAILABLE NOW

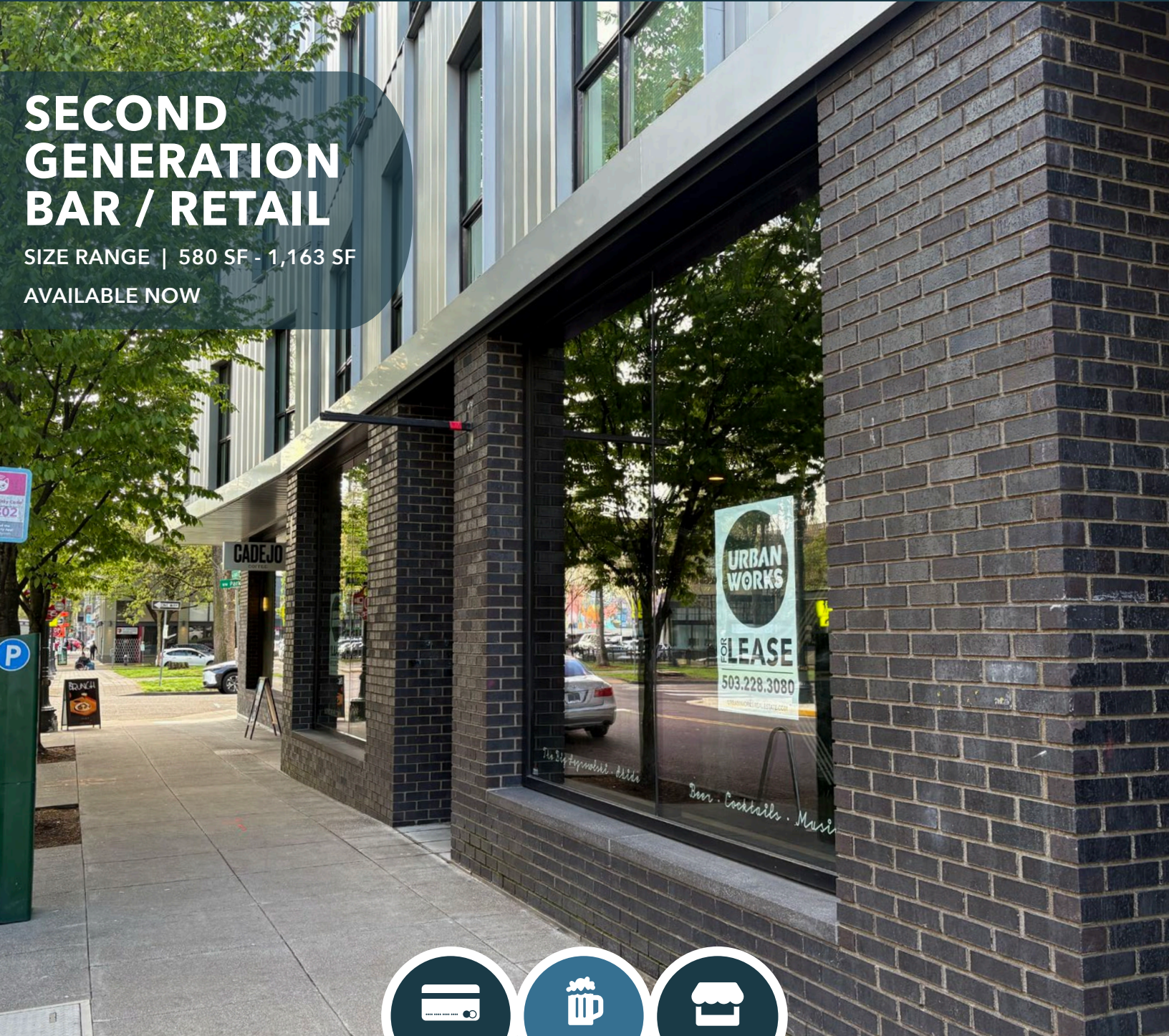

RETAIL



BAR



SERVICE

ARTHOUSE

812 NW COUCH ST

DAN BOZICH | 503.228.3135
dbozich@urbanworksrealestate.com

KIA HARTLEY | 503.228.3209
khartley@urbanworksrealestate.com

urbanworksrealestate.com

GROUND FLOOR RETAIL

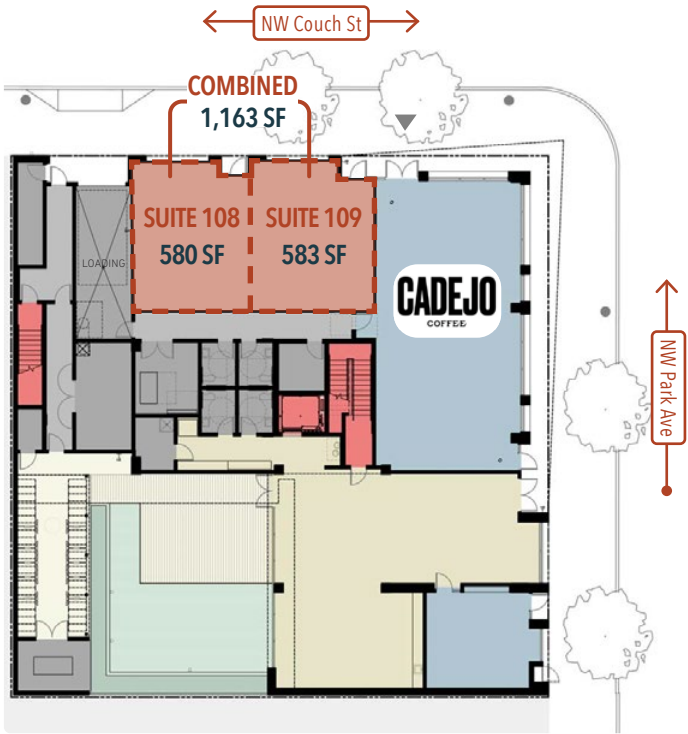

About the Space

This second generation bar space fronts the bustling intersection of NW Couch St & NW Park Ave, just two blocks east of the Brewery Blocks and Portland's West End neighborhoods.

Space Features

- Built-in bar with prep area
- Two ADA restrooms

Please note there is no Hood System in place

Address	812 NW Couch St
Area	North Park Blocks / Pearl District
Space	580 SF - 1,163 SF
Uses	Bar / Retail / Service

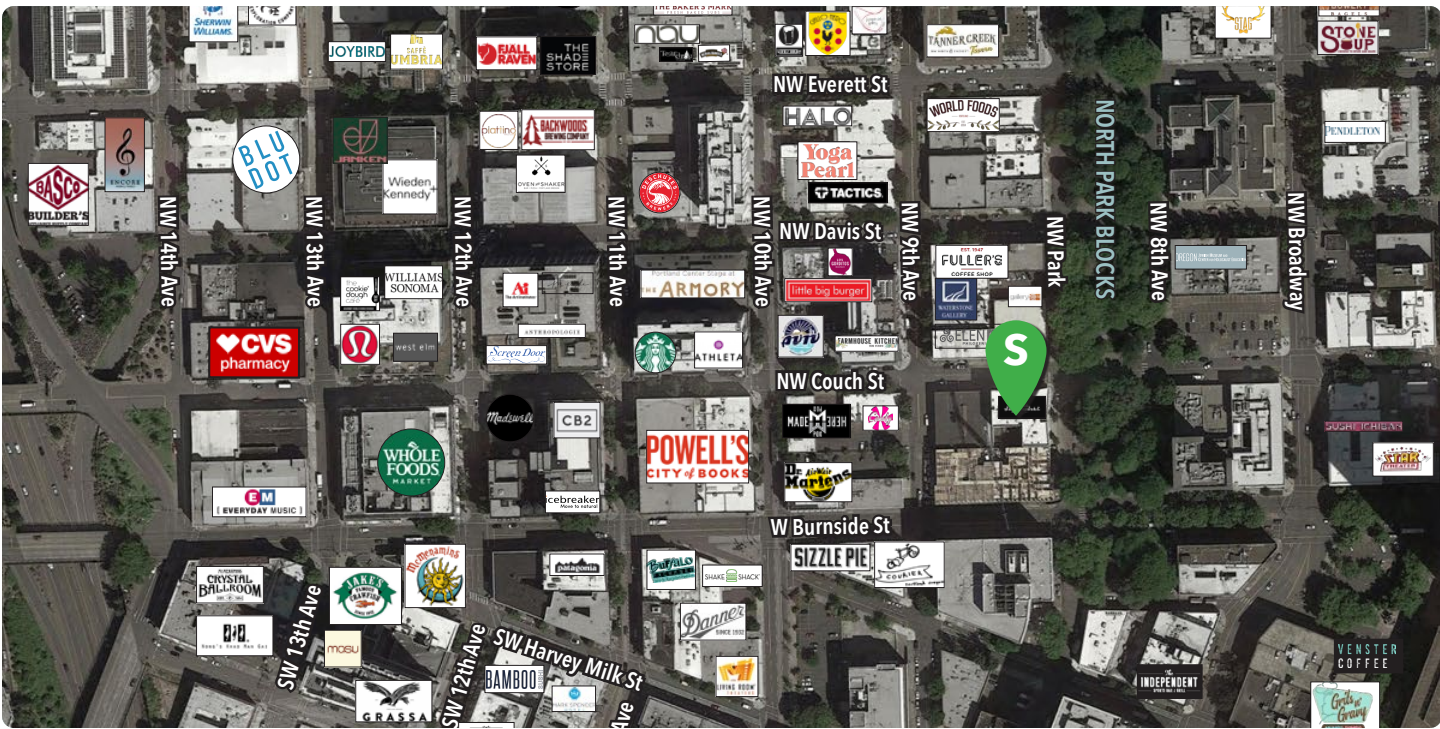

INFORMATION CONTAINED HEREIN IS FROM SOURCES DEEMED RELIABLE, BUT NOT GUARANTEED.

LOCATION



Demographics	¼ Mile	½ Mile	1 Mile
2026 Population	6,662	22,841	58,573
Total Employees	17,083	53,486	103,930
Total Businesses	1,615	4,552	9,095
Median Household Income	\$80,067	\$76,251	\$77,925
Median Age	43.6	42	38.9
Any College	80.4%	74.8%	81.7%



North Park Blocks

North Park Blocks & The Pearl District

These retail opportunities are in a premier location for retail, restaurants & bars. Situated adjacent to the Pacific Northwest College of Art, the neighborhood's mix of high density housing combined with strong daytime employment attract some of the highest foot traffic counts in the area. The neighborhood blends beautifully renovated historic warehouse buildings with state-of-the-art new housing, retail and office projects. Portlanders and tourists alike converge in this neighborhood to experience the mix of national, regional and local retailers.



Powell's

