



FOR SALE **URBAN WORKS**

RETAIL INVESTMENT PROPERTY
2236 - 2310 NE BROADWAY
PORTLAND, OR

PLEASE DO NOT DISTURB TENANTS
OR NOTIFY TENANTS OF THIS OFFERING

Charlotte Larson | 503.228.3165 | clarson@urbanworksrealestate.com
urbanworksrealestate.com





RETAIL INVESTMENT PROPERTY

ADDRESS | 2236 - 2310 NE BROADWAY
PORTLAND, OR

YEAR BUILT	1928
BUILDING SIZE	9,000 SF
LOT SIZE	9,000 SF
ZONING	CM2d
PRICING	Please call for pricing and pro forma

CONFIDENTIAL LISTING
PLEASE DO NOT DISTURB TENANTS
OR NOTIFY TENANTS OF THIS OFFERING



SUMMARY

Charming NE Broadway corridor retail investment property for sale. Featuring beautiful architectural details, there are 3 tenants in 9,000 SF. This asset is anchored by long time NE Portland business Eyes on Broadway. The neighboring tenants include The Realm Refillery and Wolf & Shadow Tattoo. The surrounding neighborhoods provide robust demographics and a loyal customer base.



DEMOGRAPHICS	¼ MILE	½ MILE	1 MILE
2024 POPULATION	2,630	8,332	29,656
TOTAL HOUSEHOLDS	1,412	4,576	15,458
MEDIAN HH INCOME	\$102,285	\$107,185	\$113,657
TOTAL BUSINESSES	246	801	3,138
TOTAL EMPLOYEES	1,701	4,604	28,848





SITE PLAN

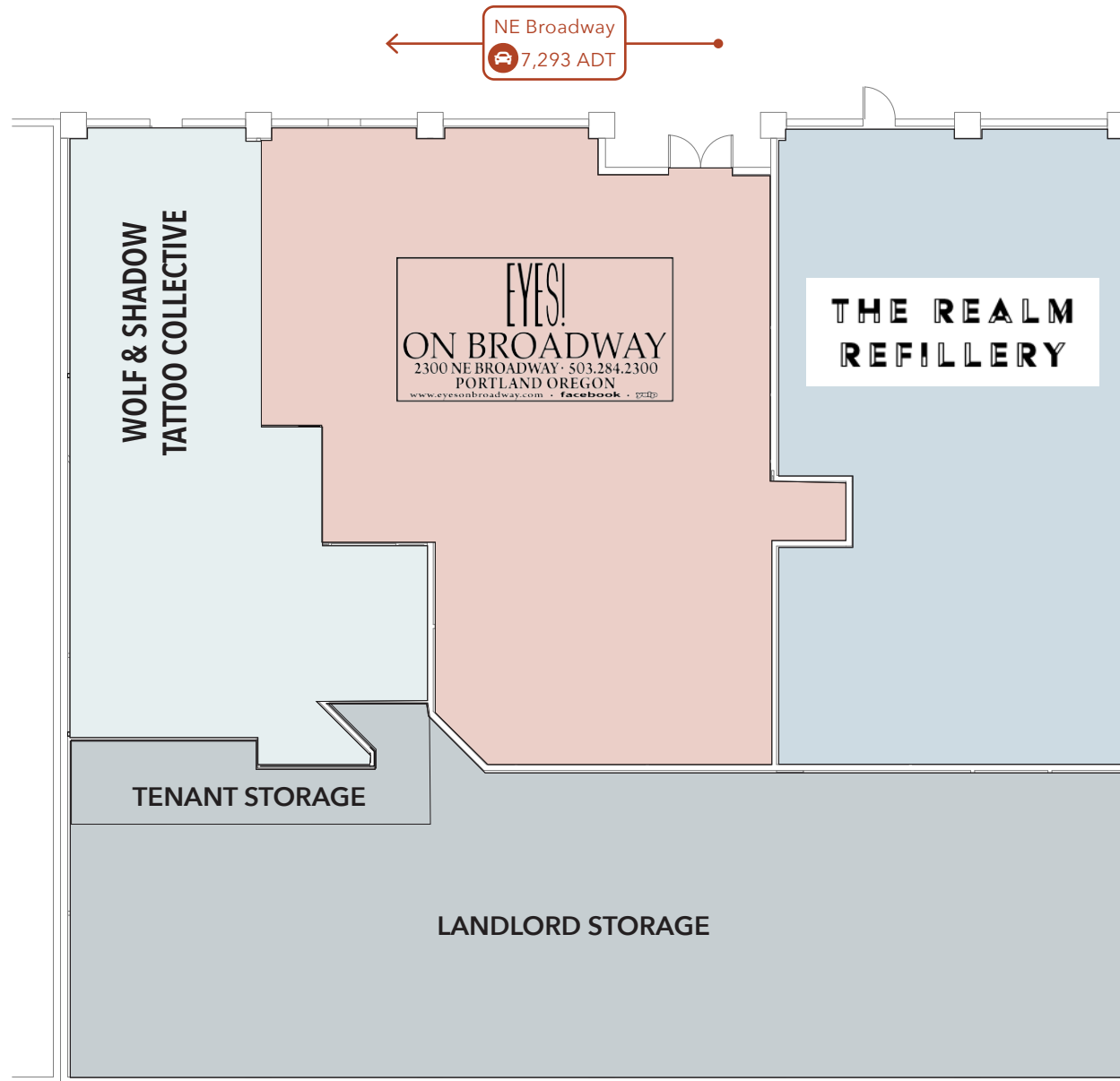



TENANT MIX

RETAIL SPACES FRONTING NE BROADWAY



EYES ON BROADWAY - 2,540 SF

Iconic Portland business offering optometry services and retail eyewear sales.

THE REALM REFILLERY

THE REALM REFILLERY - 1,980 SF

Environmentally sustainable package free neighborhood grocer.



WOLF & SHADOW TATTOO - 1,940 SF

Tattoo shop specializing in kindness and body art.



The Realm Refillery



Wolf & Shadow Tattoo Collective





MARKET AREA

IRVINGTON

This delightful retail property is located in the Irvington Neighborhood in NE Portland. Anchored by robust demographics, a walkable neighborhood retail environment and high traffic counts, this is a stable, low maintenance investment.



Providore



Peet's Coffee

