

FOR LEASE

URBAN
WORKS

SOUTH HILLSBORO AREA RETAIL SPACE

AVAILABLE NOW | 1,120 SF - 3,120 SF

YOUR SIGN



TV HIGHWAY MARKETPLACE

2935 SE 73RD AVE | HILLSBORO

TYLER BRUSS | 503.228.3274
tbruss@urbanworksrealestate.com

BRIAN GREELEY | 503.228.3147
bgreeley@urbanworksrealestate.com

urbanworksrealestate.com

TV HIGHWAY MARKETPLACE



 25,413 CPD
ON TV HIGHWAY

About the Space

- Rare, corner vacancy with existing salon infrastructure with dedicated parking field.
- Located in the heart of the new South Hillsboro district which will include over 8,000 new residential housing units and 20,000 new residents.
- TV Highway Marketplace offers retailers and service providers a rare opportunity adjacent to the largest master planned community in Oregon.
- Conveniently located between two national grocers with active co-tenancy.
- Dedicated pylon sign gives tenant's visibility to 25,413 cars per day.

Address

2935 SE 73rd Ave

Area

Hillsboro / Reed's Crossing

Available Space

1,120 SF - 3,120 SF

Timing

Available Now

Uses

Retail / Salon / Service / Wellness



FLOOR PLAN & SITE PLAN

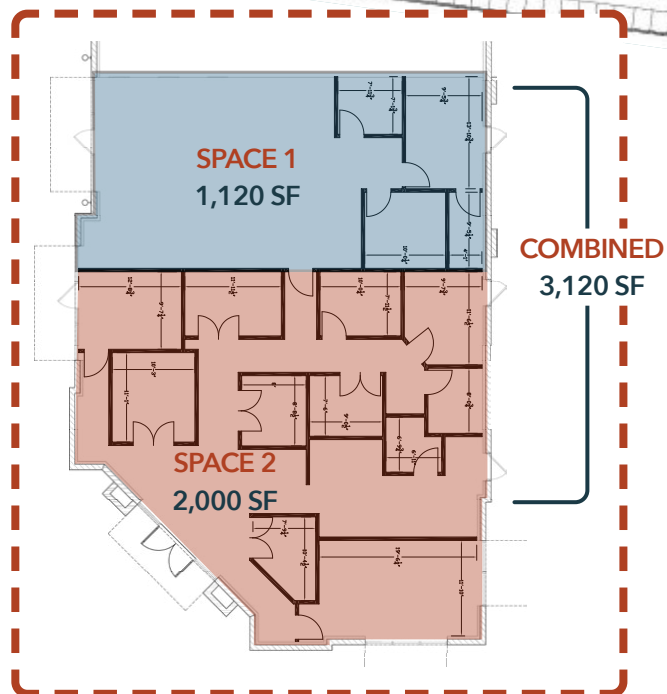
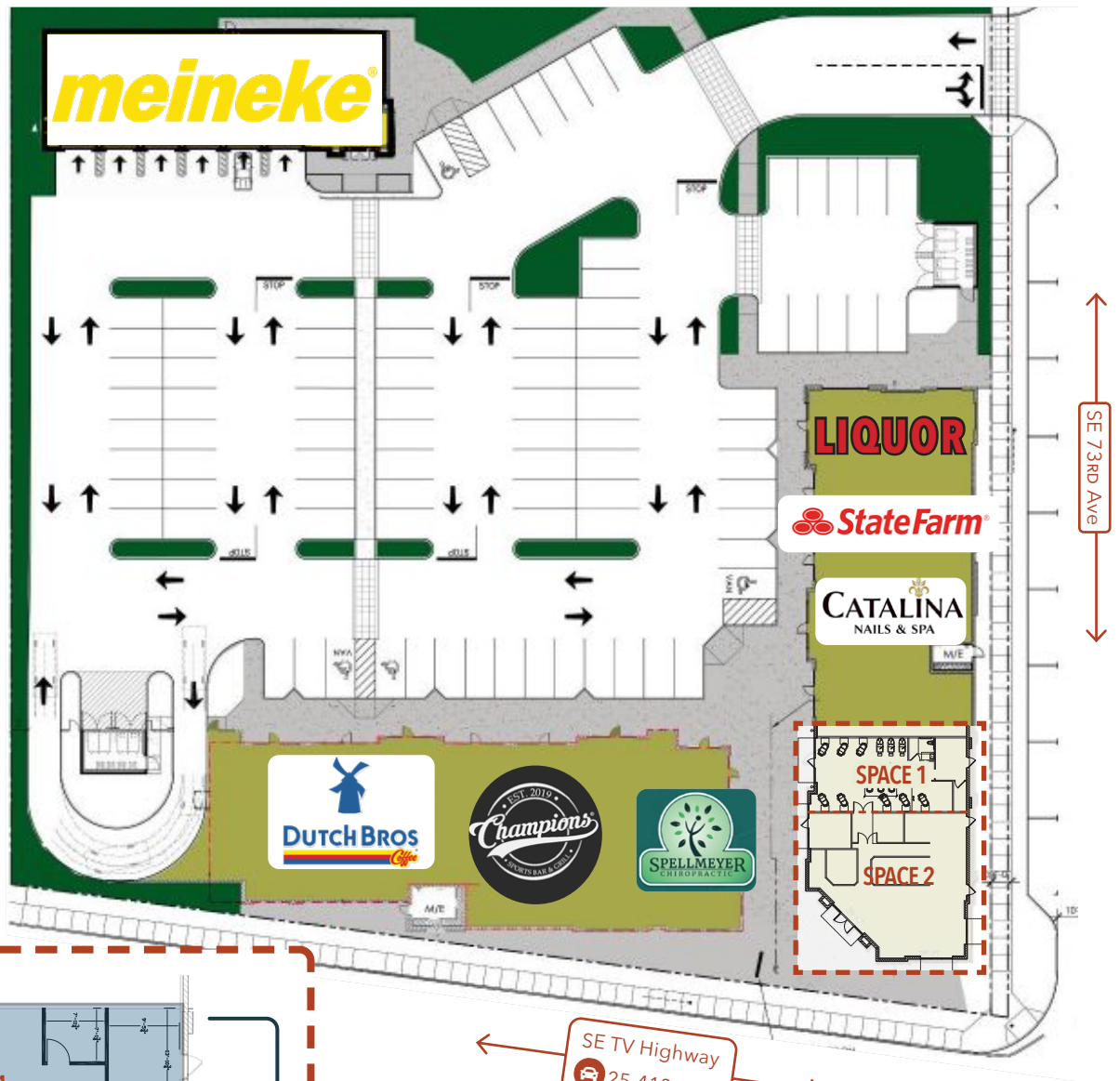

NEIGHBORHOOD



Demographics	½ Mile	1 Mile	3 Miles
2026 Population	2,225	15,775	134,820
Total Employees	896	2,960	28,412
Total Businesses	152	462	3,983
Median Household Income	\$98,403	\$125,809	\$112,432
Median Age	38.5	36.8	35.8
Any College	64.5%	74.9%	72.7%



INFORMATION CONTAINED HEREIN IS FROM SOURCES DEEMED RELIABLE, BUT NOT GUARANTEED.