

FOR LEASE

URBAN
WORKS

YOUR SIGN

4
3
3
0

prescott

4320 N Interstate Ave

Suites | 1,239 RSF - 1,267 RSF

Available Now!



YOUR
SIGN

YOGA
&
HIIT
&
RUN
CLUB

4
3
3
0

DAN BOZICH | 503.228.3135

dbozich@urbanworksrealestate.com

KIA HARTLEY | 503.228.3209

khartley@urbanworksrealestate.com

urbanworksrealestate.com



The Building

Turn-key spaces available in Prescott, a 155 unit apartment building conveniently located in the Overlook neighborhood.

Space 1 - Retail / Service | 1,239 RSF

- Second generation retail / service space
- Wood floors
- Sink

Space 2 - Retail / Service | 1,267 RSF

- Glass window line with southern light exposure
- Tall ceilings with polished concrete floors
- Three-compartment sink and hand sink
- One ADA Restroom

prescott

4320 N Interstate Ave

Overlook / Close-in NE Portland

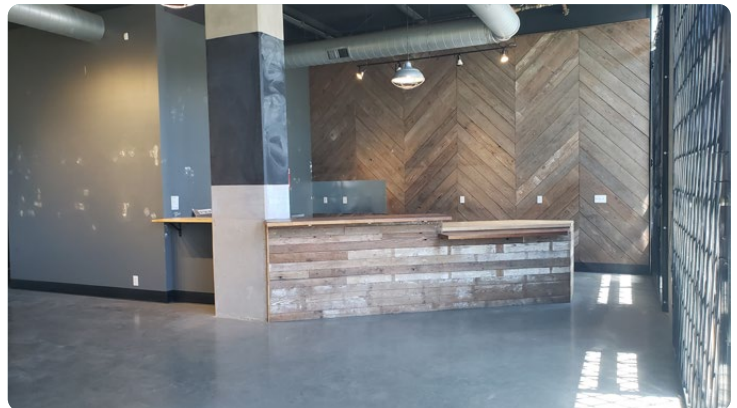

SITE PLAN

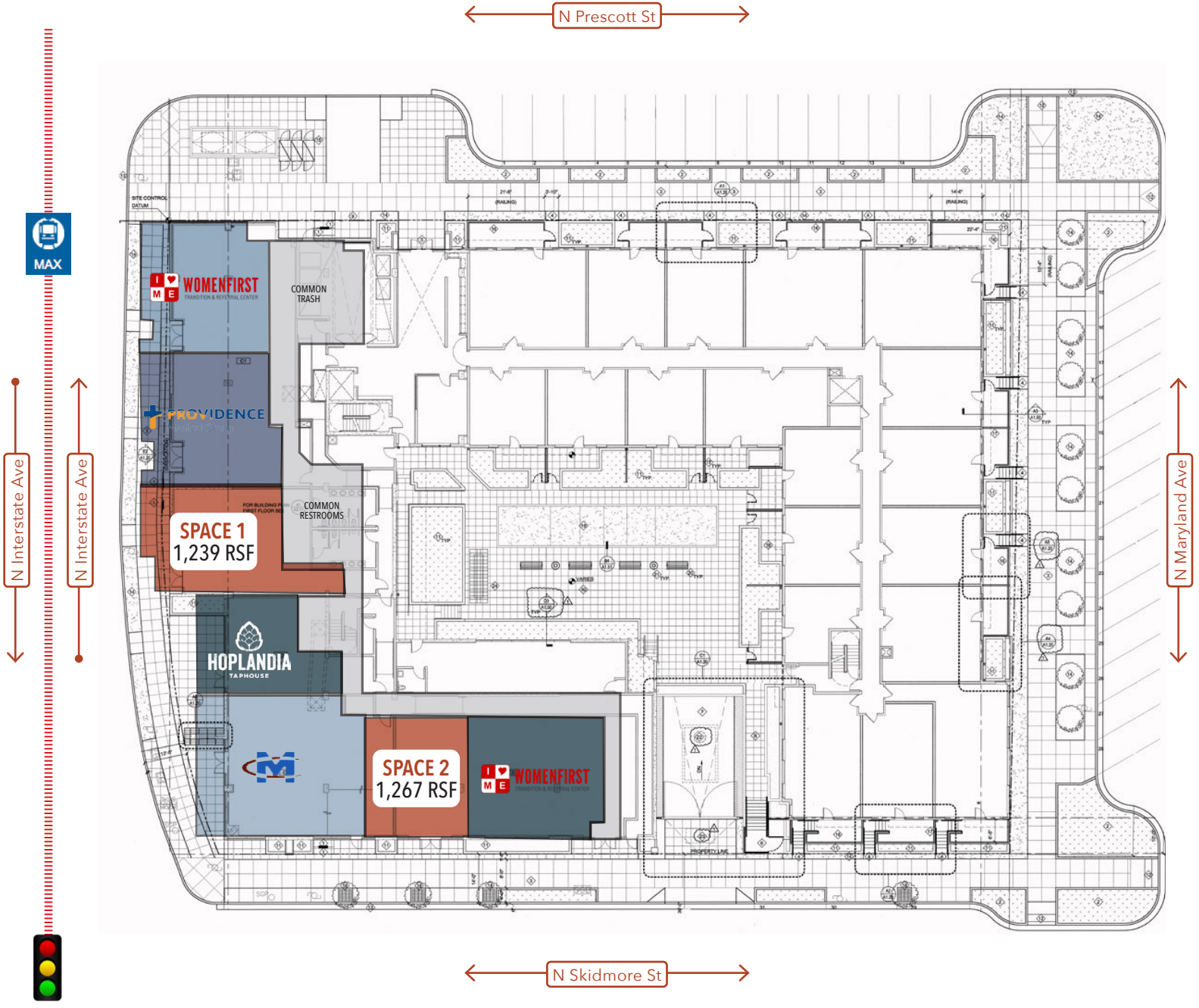

RETAIL MAP



Demographics	¼ Mile	½ Mile	1 Mile
2026 Population	1,780	7,349	22,498
Total Employees	512	2,357	8,842
Total Businesses	104	436	1,322
Median Household Income	\$111,145	\$110,043	\$105,344
Median Age	35.7	35.5	35
Any College	76.6%	78.8%	82.1%

